

Mi Smart Water Purifier RO+UV User Manual



Xiaomi

Installation Service

1. Use one of the following two options to book an appointment to have the water purifier installed:
 - a. Call 18001036286 to book an appointment.
 - b. Go to www.mi.com/in/service/repair and follow the process to book your appointment.
2. It is not recommended for users to install the water purifier by themselves, please contact the Mi customer service to book an appointment to have the water purifier installed by a qualified technician. The user shall be held responsible for any damage, loss, or personal injury caused by installing the purifier by themselves.

Instructions

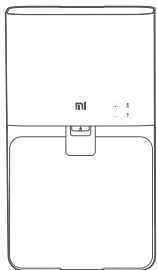

How to get drinkable water

It will automatically start rinsing the filter, which needs to be rinsed twice. After that it will take about 1 hour to fill the tank.

How to consume

Directly press or pull up the water dispenser tap for water consumption. Once the water level in the tank drops below the set minimum, the purifier will automatically start filling the tank.

Scope of Use

This product is suitable for filtering potable water.

Table of Contents

Precautions	1
Product & Accessories	3
Product Overview	4
Installation Instructions	5
Installing Filters	5
Recommended Filter Replacement Cycle	6
Connecting with Mi Home / Xiaomi Home App	6
Resetting Wi-Fi	7
Filter Service Life & Filter Purchase	7
Replacing Filters	7
Troubleshooting	8
Specifications	9
Water Treatment Diagram	9
Electrical Diagram	9

Read this manual carefully before use, and retain it for future reference.

Precautions

Antifreeze

Do not store or use the water purifier in environments with ambient temperatures below 4°C.

Water source pressure

This water purifier only operates on a pressure range between 0.03-0.4 MPa. Product may not work or work abnormally, if water pressure is not as per specified limit.

Routine Maintenance

In the event of a failure, quickly close the water supply and unplug the water purifier. Call 18001036286 or go to www.mi.com/in/service/repair to book an appointment.

This water purifier needs to be repaired by an authorized technician. Do not disassemble the water purifier nor its accessories.

When moving or transporting the water purifier, it should be handled according to the label on the package so as to avoid damage by improper handling.

Do not clean the exterior and interior of the water purifier with water.

Sweep the exterior with dry and clean cloth.

Cleaning the interior with water may cause odors and bacteria.

When a filter needs to be replaced, the corresponding indicator will be orange or blink orange. Please purchase the corresponding filter and replace it as soon as possible.

Usage

Please connect the Mi Smart Water Purifier (RO + UV) to Wi-Fi for a better user experience.

Unplug the water purifier and close the water supply to the purifier if you do not plan to use it for more than a week. When you start using it again, open the water dispenser tap and drain the purified water thoroughly. Then open the water supply and plug in the water to start purifying water. After about 1 hour, the water tank will be filled up, and then drain it again. Then you can resume using the water purifier.

Unplug the water purifier and close the water supply to the purifier, when repairs or maintenance to the main water supply are being carried out. After the main water supply has been restored, please open other taps to get rid of any sand before using the purifier. Otherwise, large amounts of sediment in the tap water may cause the purifier's filters to get blocked.

It is normal for the purified water flow to decrease when the tap water quality is bad and the water temperature and pressure are lower.

It is normal for the water purifier to slightly vibrate and make some noise. This is caused by the booster pump when it is purifying water.

Do not place the water purifier on its side or upside down.

The water purifier may get damaged if the inlet water temperature is below 5°C or above 38°C.

Do not use this water purifier for commercial purposes.

Cleaning the water tank: It is recommended to clean the water tank every two months.

Steps:

1. Unplug the water purifier, and close the water supply to the purifier.
2. Remove the water tank cover and check whether there is sufficient water in the tank.
3. Add about 150–200 ml of citric acid into the water tank, and clean with a cleaning cloth, then drain the water via the water dispenser tap.
4. Plug in the water purifier, and open the water supply to the purifier. Let it fill up the water tank, and then drain it again.
5. Once the water tank is filled up again, the purified water is ready for consumption.

Accessories & Filters

To ensure normal operation and safe water quality, only use genuine accessories and filters provided by our company.

Storage

Avoid using and storing the water purifier in the following environments:
Locations exposed to strong direct sunlight, as these can easily cause ageing to certain parts of the water purifier.

Environments with temperatures below 4°C or above 40°C, as these may cause damage to the water purifier or its filters.

Near high temperature or strong magnetic appliances, as these may cause a fire or electrical circuit failure.

Damp or dusty environments, as these may cause damage to the electrical circuit.

Do not place any heavy objects or liquids on the top of the water purifier.

Children & Mentally Disabled People

This appliance can be used by children aged from 8 years and above and persons with reduced physical, sensory or mental capabilities or lack of experience and knowledge if they have been given supervision or instruction concerning use of the appliance in a safe way and understand the hazards involved.

Children shall not play with the appliance.

Cleaning and user maintenance shall not be made by children without supervision.

Discard of the packaging immediately after removing it, and keep it away from children.

Do not let children use, or come near the water purifier.

Children and mentally disabled people should only use the water purifier under the supervision of a guardian.

Additional Precautions

Do not bend, twist, or pull the power cord so as to avoid damage to it.

Appliances that are obviously damaged must not be operated. When the power cord is accidentally damaged, please contact the after-sales service to have it replaced.

Always unplug the water purifier by pulling the power plug, rather than the cord.

Please keep the power plug clean, and do not plug or unplug it with wet hands.

Please place the water purifier in place that is safe from pests, so as to prevent the power cord and hoses from being bitten.

Properly fasten the water hoses before use. Immediately unplug the water purifier and close the water supply to the purifier, in case of a leak.

Do not let the product come into contact with or near a heat source or an open flame.

Do not place flammable, explosive, volatile, or magnetic substances near the water purifier.

Do not use a step-up transformer to connect the water purifier to a power outlet.

Do not clean the water purifier directly with water, nor submerge it in water.

This water purifier uses the reverse osmosis filtration principle, which will produce a certain amount of waste water during its process.

The water quality, inlet pressure, inlet temperature, water purifier's usage time and usage habits all have an impact on the raw water purifying efficiency.

The new water hoses included with the purifier should be used. Do not reuse any old water hose.

The remaining filter life is calculated based on the time the filter is installed and used, and the time that the purifier is not purifying is also included.



CAUTION
UV LIGHT HAZARD
AVOID LOOKING DIRECTLY AT LIGHT

This water purifier comes with a UV sterilization feature which helps to protect water from micro organisms which gets generated in the tank. Direct exposure to the light is strictly prohibited as it may cause eye irritation and skin allergies.

WARNING: Do not operate the UV-C emitter when it is removed from the appliance enclosure.

Appliance contains a UV-C emitter.

Unintended use of the appliance or damage to the housing may result in the escape of dangerous UV-C radiation. UV-C radiation may, even in little doses, cause harm to the eyes and skin.

The replacement of the UV-C emitter by the user is not allowed.

Product & Accessories

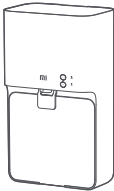
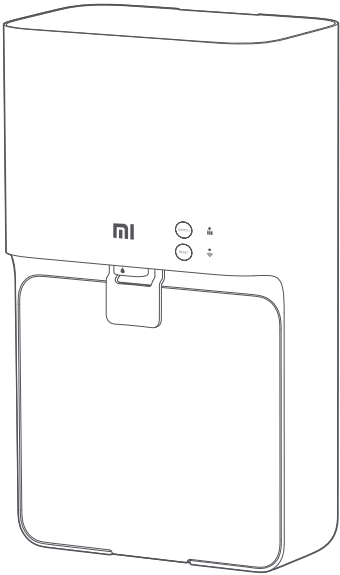

Water Purifier (including power cord)



Filters:
PP Cotton & Activated Carbon filter (PPC) × 1
Reverse Osmosis Membrane filter (RO) × 1
Post Activated Carbon filter (PAC) × 1



User Manual × 1



PE Hose × 2



Inlet Valve × 1



Clamp × 3



Wall Mounting Screw × 2



Wall Plug × 2

Illustrations of product, accessories, and user interface in the user manual are for reference purposes only. Actual product and functions may vary due to product enhancements.

Product Overview

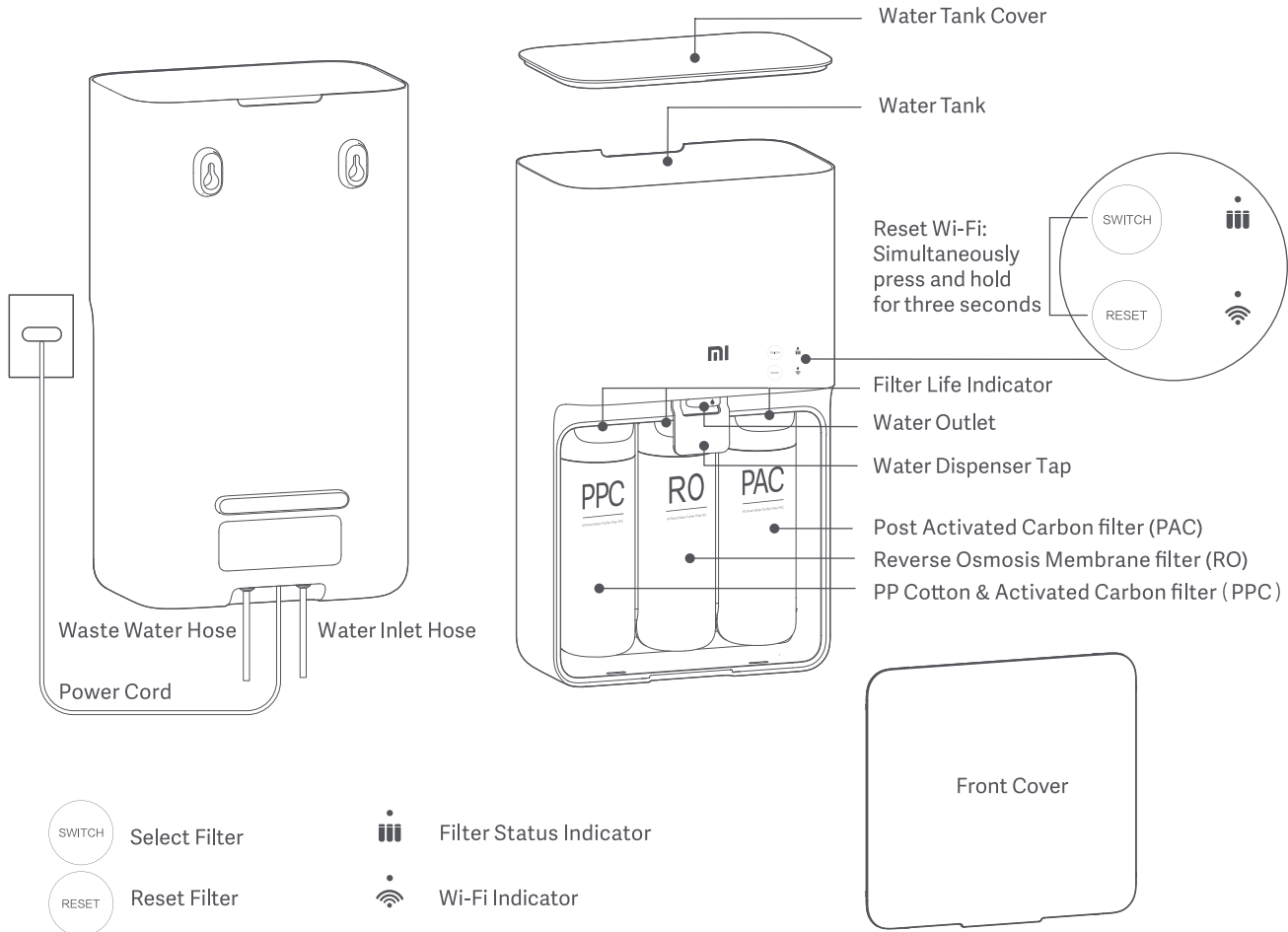

Installation Instructions

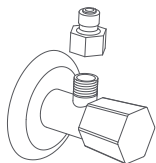

1. Take the adapter included in the accessories and install it on the water shut-off valve.

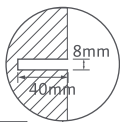

2. Use the drilling template to mark the positions of the holes on the wall, and then use an appropriate M8 drill to drill two holes of about 40 mm deep.



3. Insert the wall plugs, and turn the screws in them. Leave about 4 mm between the head of the screws and the wall.

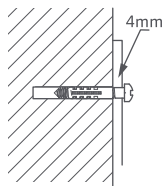

4. Connect the water inlet hose and the waste water hose to the corresponding connectors in the holes at the bottom of the water purifier, and then hang the purifier on the wall. Connect the water inlet hose to the adapter, and place the waste water hose into the sink.

Precautions:

Check whether the waste water hose is bent, crushed, damaged, or blocked, as this will seriously affect the working of the water purifier. The water from the waste water hose is not drinkable, it contains sediment, rust, chlorine, etc. It is recommended to be drained directly, or collected to use for cleaning, washing, and watering purposes.

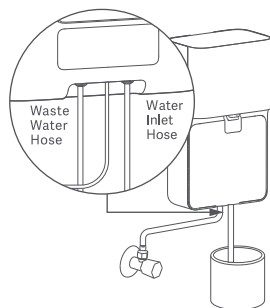

Installing Filters

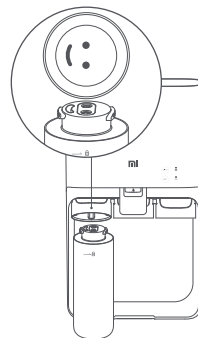



Figure 1

01. Remove the packaging from the filters.

02. Tilt the connector and align the filter with the connector (Figure 1).

03. Insert the filter and turn it clockwise until  is aligned with PPC (Figure 2).

04. Complete the installation of all three filters in order (Figure 3).

05. Completely rinse the filters.

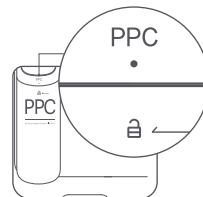

Figure 2

Open the water supply and plug in the water purifier to start water purification. The purified water will be stored in the water tank which will be completely filled up about 1 hour. After it stops, drain the purified water by opening the water dispenser tap, and close it once the tank is completely empty. Repeat the previous steps. Then the rinsing process of the water purifier is completed now.

Note: The first rinse is to clean the filters and water circuit. Water produced at this stage may be charcoal grey and contain bubbles, this is normal. Please rinse twice to get drinkable water.



Figure 3

Recommended Filter Replacement Cycle

Stage	Filter Name	Description	Effectively Removed Substances	Replacement Cycle
First stage	PP Cotton & Activated Carbon filter (PPC)	Can intercept large and visible particles, and deeply adsorb residual chlorine, color, odour, organic matter and other harmful substances from the water.	Rust, sediment, fibers and other visible matter. Furthermore, colors, odour, residual chlorine, trichloromethane, organic substances such as carbon tetrachloride.	No longer than 12 months
Second stage	Reverse Osmosis Membrane filter (RO)	Can effectively filter out heavy metals, bacteria, viruses, antibiotics, scales, organic matter and other impurities. The theoretical filtration precision can reach 0.0001 micron.	Heavy metals, bacteria, viruses, limescale, organic matter, etc.	No longer than 12 months
Third stage	Post Activated Carbon filter (PAC)	Can effectively absorb odour and some organic substances from the water. Furthermore, it can effectively improve the taste.	Odour, organic substances	No longer than 12 months

Note:

- The filter's service life and replacement cycle depends on the quality, pressure and temperature of input water.
- Filter life is defined as per standard lab test condition.
- Please replace filters periodically according to the notifications.
- The three filters can be replaced simultaneously or separately, according to the purifier's actual use.

Connecting with Mi Home / Xiaomi Home App

This product works with Mi Home / Xiaomi Home app*. Control your device with Mi Home / Xiaomi Home app.



Scan the QR code to download and install the app. You will be directed to the connection setup page if the app is installed already. Or search "Mi Home / Xiaomi Home" in the app Store to download and install it.

Open Mi Home / Xiaomi Home app, tap "+" on the upper right, press the "Devices nearby" button to search the water purifier, and then follow prompts to connect your water purifier.

* The app is referred to as Xiaomi Home app in Europe (except for Russia). The name of the app displayed on your device should be taken as the default.

Note:

The version of the app might have been updated, please follow the instructions based on the current app version.

Resetting Wi-Fi

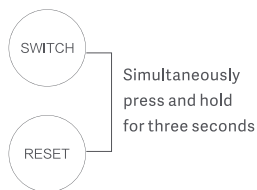

When the Wi-Fi needs to be reset due to connection problems or changing the router, simultaneously press and hold the SWITCH and the RESET button for three seconds. The Wi-Fi indicator will blink orange and you will hear three beeps, then the Wi-Fi has been reset successfully.

Filter Service Life & Filter Purchase



Filter Status Indicator

When the filter is nearly exhausted, the filter life indicator on the water purifier will blink orange. When the filter is exhausted, the filter life indicator on the water purifier will be orange.

Filters Purchase

Purchase on www.mi.com/in
Purchase via the Mi Home app.

Replacing Filters

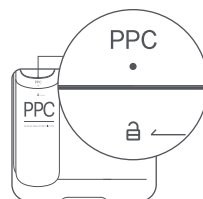

Figure 1



Figure 2

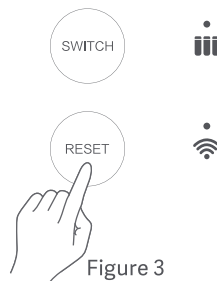

Figure 3

- 01 Unplug the water purifier, and close the water supply to the purifier.
Open the water dispenser tap and drain the water in the tank.
Remove the front cover, lift the filter that needs to be replaced and turn it counterclockwise to remove it.
- 02 Refer to steps 01–03 on page 5 the Installing Filters section to install new filters (Figure 1 and 2).
- 03 After turning on the water purifier, press the SWITCH button to select the filter that needs to be reset. The indicator light of the corresponding filter will blink orange. Press and hold the RESET button for three seconds until you hear three beeps to indicate the filter has been reset successfully. Then the indicator light of the corresponding filter will blink blue (Figure 3).

Note:



- Please make sure the filter is reset otherwise the filter life cannot be calculated.
- SWITCH button description: You can select all three filters, or the first stage filter, the second stage filter, and the third stage filter individually by pressing the SWITCH button.

04 Open the water supply to rinse the new filters. Refer to step 05 on page 5 of the Installing Filters section to rinse the new filters.

Note: The first rinse after installing new filters is to clean the filters and water circuit. Water produced at this stage may be charcoal gray and contain bubbles, this is normal. To get drinkable water, please rinse filters 2 times.

Troubleshooting

Indicator Status Description

Indicator	Status	Possible Causes	Solutions
	Blinking orange	Filter is nearly exhausted	Open the front door, check which filter is exhausted and replace it as soon as possible
	Orange	Filter is exhausted	
	Quickly blinking orange	Wi-Fi is awaiting connection or is not connected	Enhance the Wi-Fi network signal or reset the Wi-Fi network connection
	Quickly blinking blue	Wi-Fi is offline or connecting	
	Blinking orange	Filter is nearly exhausted	Purchase a new filter and replace it as soon as possible
	Orange	Filter is exhausted	

Issue Description

Issue	Possible Causes
No water purification	<p>Check whether the power cord is connected properly.</p> <p>Check whether the water supply is available.</p> <p>Check whether the filters are installed properly.</p> <p>Check whether the installed filters are genuine.</p> <p>Check whether the filters need to be replaced.</p> <p>Check whether the tap water temperature is over 38°C.</p> <p>Check whether the tap water pressure is too low.</p> <p>Check whether the tap water hose or waste water hose is bent or damaged.</p>
No waste water coming out from drain hose	<p>Check whether the waste water hose is bent or blocked.</p>
Low tank filling rate	<p>Check whether the filters are blocked or exhausted.</p> <p>Check whether the tap water's temperature or pressure is too low.</p> <p>Check whether the water purifier is overheated due to continuous use. If so, let it cool down before using it again.</p>
Purified water's TDS is high	<p>Check whether the tap water's TDS is high.</p> <p>Check whether the water purifier has not been used for a long time.</p> <p>Check whether the filters need to be replaced.</p>

Specifications

Name	Mi Smart Water Purifier (RO + UV)
Model	MRB13
Product Dimensions	30 cm x 20.7 cm x 52.3 cm
Scope of Use	Local tap water
Applicable Water Temperature	5°C to 38°C
Wi-Fi Connection	Yes
Purified Water Flow Rate	0.13 L/min.*
Tank Capacity	7 L
TDS Reduction	Up to 90%*
Input Water Condition	
Water Pressure	0.03–0.4 MPa
TDS	<2000mg/L
Hardness	<500mg/L
Turbidity	<10NTU
Chlorine	<1mg/L
pH range	6.5-8.5
Iron Content	<0.3mg/L
Rated Voltage	220–240 V ~
Rated Frequency	50 Hz
Rated Power	42 W
Anti-shock Protection Type	Class II
Net Weight	6.7 kg

Note:

- Purified water flow rate and TDS reduction is completely dependant upon the input water condition.
- Filter life is defined as per standard lab test condition.
- Please replace filters periodically according to the notifications.
- The three filters can be replaced simultaneously or separately, according to the purifier's actual use.

Water Treatment Diagram

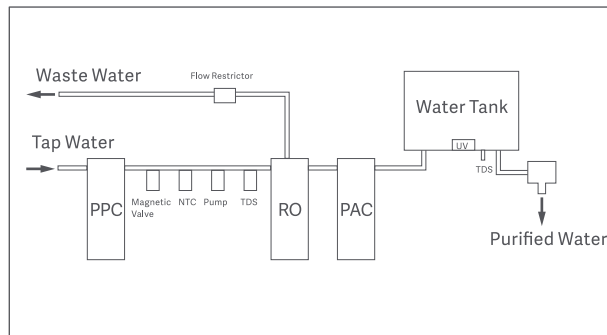

Electrical Diagram

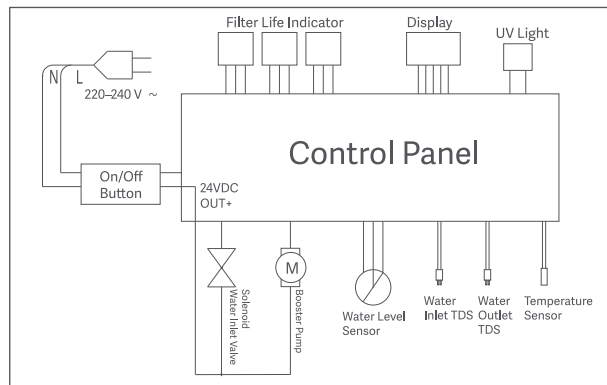

All products bearing this symbol are waste electrical and electronic equipment (WEEE as in directive 2012/19/EU) which should not be mixed with unsorted household waste. Instead, you should protect human health and the environment by handing over your waste equipment to a designated collection point for the recycling of waste electrical and electronic equipment, appointed by the government or local authorities. Correct disposal and recycling will help prevent potential negative consequences to the environment and human health. Please contact the installer or local authorities for more information about the location as well as terms and conditions of such collection points.



EU Declaration of Conformity

We Foshan Viomi Electrical Technology Co., Ltd., hereby, declares that this equipment is in compliance with the applicable Directives and European Norms, and amendments. The full text of the EU declaration of conformity is available at the following internet address: <http://www.mi.com/global/service/support/declaration.html>



Manufactured by: Foshan VIOMI Electrical Technology Co., Ltd.

Address: 4F, Building 7 & 2F, Building 1, No. 2 North of Xinxi Fourth Street, Xiashi Village Committee of Lunjiao Sub-district Office, Shunde District, Foshan City, Guangdong Province, China

Imported by: Xiaomi Technology India Pvt. Ltd., Orchid (Block E), Embassy Tech Village, Devarabeesanahalli, Marathahalli-Sarjapur Outer Ring Road, Bangalore – 560103, Karnataka

For Consumer Complaints Contact: Manager, Customer Care, Xiaomi Technology India Pvt. Ltd., Ground Floor, AKR Infinity, Sy. No.113, Krishna Reddy Industrial Area, 7th Mile, Hosur Road, Bangalore- 560 068, Karnataka , Phone No. 1800 1036286, Email: service.in@xiaomi.com

For further information & product warranty T&C, please go to www.mi.com/in

User Manual Version: 1.0